

URBA

nhow
ROTTERDAM

URBA*





art, architecture and one hell of a view

welcome to nhow Rotterdam. A design & lifestyle hotel where urban art and architecture become one. The hotel is located in the iconic building De Rotterdam, built by renowned architect Rem Koolhaas, located in an area known as 'Manhattan on the river Maas' and provides guests with unparalleled views and a sense of being at the heart of the city. The hotel embraces the unique identity and spirit of Rotterdam, by celebrating the city's art, architecture, and culture, nhow Rotterdam becomes more than just a place to stay, it becomes a place to truly connect with the essence of the city.

You won't want to close the curtains with a view like this. Be free, get creative, meet, relax and stay at nhow. Choose between four different room categories and don't just visit the city but become part of it with its unique skyline view.



hotel & location

Rotterdam Central Station

3.6 km / 10 min drive | 4 stops metro D/E line

Rotterdam The Hague Airport

10 km / 16 min drive metro E line | Shuttle service available

The Hague Central Station

28 km / 30 min drive | 30 min metro E line

Ahoy Rotterdam

3.9 km / 10 min drive | 3 stops metro D/E line

Schiphol Amsterdam Airport

60 km / 50 min drive | 21 min fast train





274 inspiring rooms

Divided over 23 floors, the rooms offer comfort and panoramic views over the Rotterdam Skyline, all to be enjoyed from the comfiest bed in town. You will be so close to the Erasmus bridge it will be impossible not to see it. After a restful night, the colors and shapes of the city skyline awaken your senses and prepare you for a creative and energetic day.

eat & drink

Start your day with a famous nhow breakfast. Enjoy a fluffy stack of pancakes, a freshly baked croissant and strong cup of coffee. Discover many flavors from around the world with our inspired street food menu.

Our cocktails are just as wild and colorful as the interior design from Elvy Gastrobar, immerse yourself into an urban jungle or go out to our rooftop terrace to enjoy an unparalleled view. So lean back and relax while sipping your cocktail and watching the sunset paint the skyline of Rotterdam.



gym & wellness

After an exciting day in Rotterdam, you're welcome to relax or exercise in our 70 m² gym. Break a sweat after a busy day of working in our state-of-the-art fitness center. If you'd rather take it easy, enjoy our spa area with the sauna with unbeatable views!



ROTTERDAM



host a meeting or event

nhow is the meeting place for forward thinkers. Host an event unlike anything you've ever organized in the unique, creative and fully adaptive environment of nhow Rotterdam. In one of the 11 meeting rooms, with endless flexibility and to host event for up to 500 people. Bathed in all natural light thanks to Rem Koolhaas' open architecture, all of our conference spaces have an awe inspiring view, state-of-the-art technology, local urban art and topnotch catering. We can be pretty simple about our service: we'll do just about anything to make your event a success!



the loft

Even though we have several conference rooms that are amazing, we are pretty sure that The Loft will add an extra 'wow' to your meetings & events.



The Loft is a state-of-the-art Meetings & Events venue: 700m² of fully customizable space.

The best thing is, you can not only host meetings but also throw an after drink or party as well.

- Unique open space
- Up to 400 guest capacity
- Floor-to-ceiling windows
- Custom-built mobile bar
- Movable separation walls
- Customizable lighting grid
- Top-notch F&B facilities
- Integrated audio / video facilities
- Unlimited customizability



capacity chart

room name	height (m)	area (m ²)	 cocktail	 board- room	 carré	 class- room	 theatre	 u-shape	 cabaret	 dinner	daylight
nhow 1	3.4	46.8	38	18	24	18	38	18	29	18	✓
nhow 2	3.4	50.7	50	18	24	18	50	18	30	18	✓
nhow 3	3.4	126	150	36	45	42	150	39	70	36	✓
nhow 4	3.4	148	150	36	45	42	150	39	70	36	✓
nhow 5	3.4	148	110	36	45	42	110	39	70	36	✓
nhow 6	3.4	126	110	36	45	42	110	39	70	36	✓
nhow 7	3.4	67	60	18	24	24	60	18	39	18	✓
nhow 8	3.4	66		16-	-	-	-	-		16	✓
LOFT 1	3.4	61	40	12	22	24	40	18	30	12	✓
LOFT 2	3.4	285	250	32	42	60	120	38	90	150	✓
LOFT 3	3.4	258	150	30	46	60	100	36	70	100	✓
LOFT 2+3	3.4	543	400	96	46	120	220	38	160	250	✓
nhow 3+4			300	72	84	114	300	71	140	72	✓
nhow 2+3+4			350	72	84	132	350	71	170	72	✓
nhow 2+3			200	36	45	60	200	39	100	36	✓
nhow 5+6			240	72	54	84	240	48	150	72	✓
nhow 5+6+7			300	72	54	108	300	48	150	72	✓
nhow 6+7			170	36	45	66	170	39	100	36	✓

floor plan

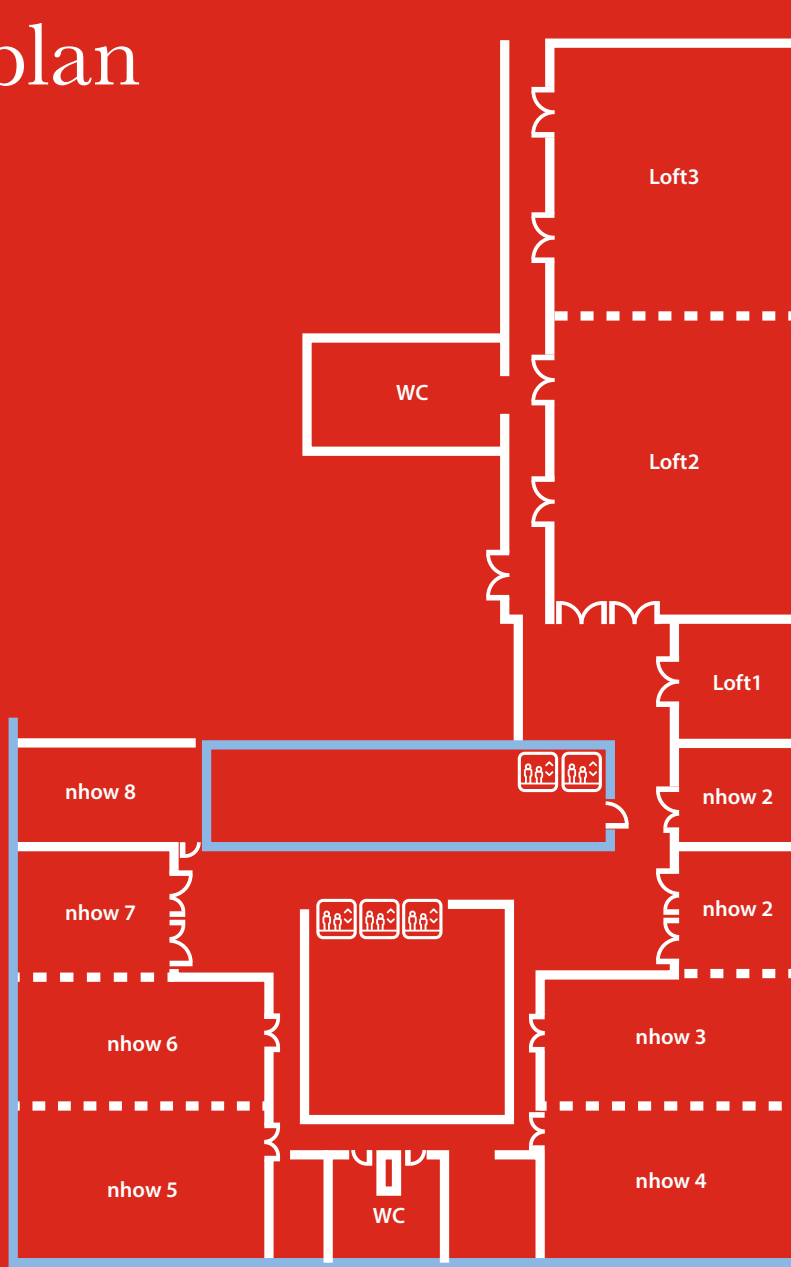

- glass
- - - - removable divisors
- wall

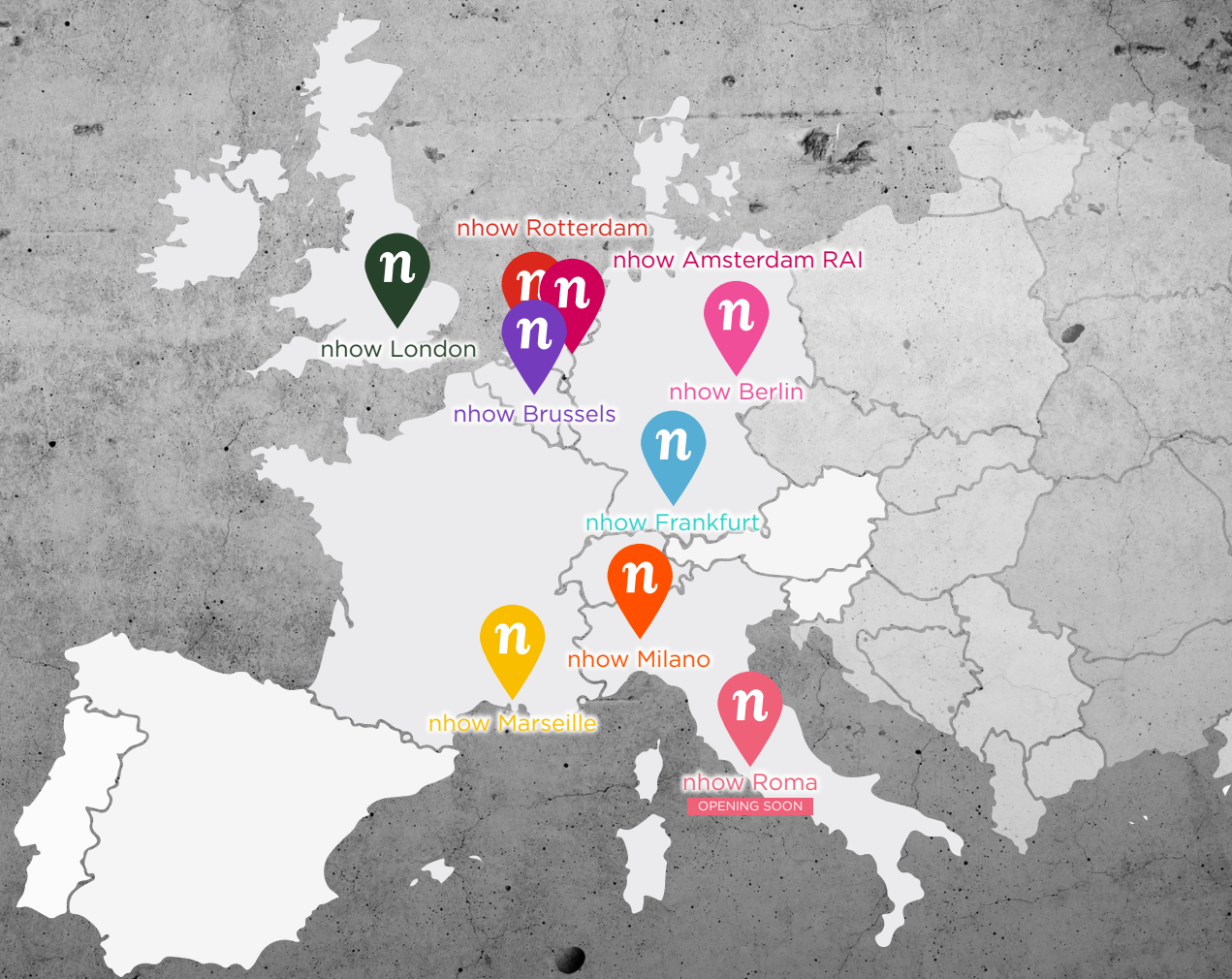

nhow London

nhow Brussels

nhow Marseille

nhow Milano

nhow Frankfurt

nhow Berlin

nhow Roma
OPENING SOON

nhow Rotterdam

nhow Amsterdam RAI

contact

nhgroupsales.nl@nh-hotels.com +31 (0)85 902 2300
Wilhelminakade 137, 3072 AP, Rotterdam, Netherlands
nhow-rotterdam.com / nhow-hotels.com